



***CP POLYMER***

*Providing the right solution with  
excellence in product and service*



## *CP Polymer Philosophy*

### **Performance and leadership in Engineering Plastics**

C&P Corporation is a thermoplastic polymer material compounder and supplier based in Korea. As a global supplier of plastics, we supply a diverse range of compounded Engineering Plastics and Masterbatch to meet performance and processability requirements across many industries and end uses. The product portfolio of CP Polymer® is engineered and manufactured to be used in extreme environments and conditions. The categories are PA6, PA66, PBT, POM, Masterbatch and specialty grades for specific application. We offer customized solutions for engineering thermoplastics and custom engineered with precision products conform to meet the specific needs of our customer's applications. Our goal is your success.

### **Creating value for customer**

Our commitment is working together with customers to drive new opportunities and set new trends that add value. C&P Corporation is continuously striving to develop newer and better compounding technologies. While our products have performed successfully in plastic applications we continue to innovate and develop new products to drive our customers' product performance. Trust and credibility must be the basis of all relationships with our customers. We believe that quality pays for itself. Therefore, we constantly strive for excellence in both product and service quality.

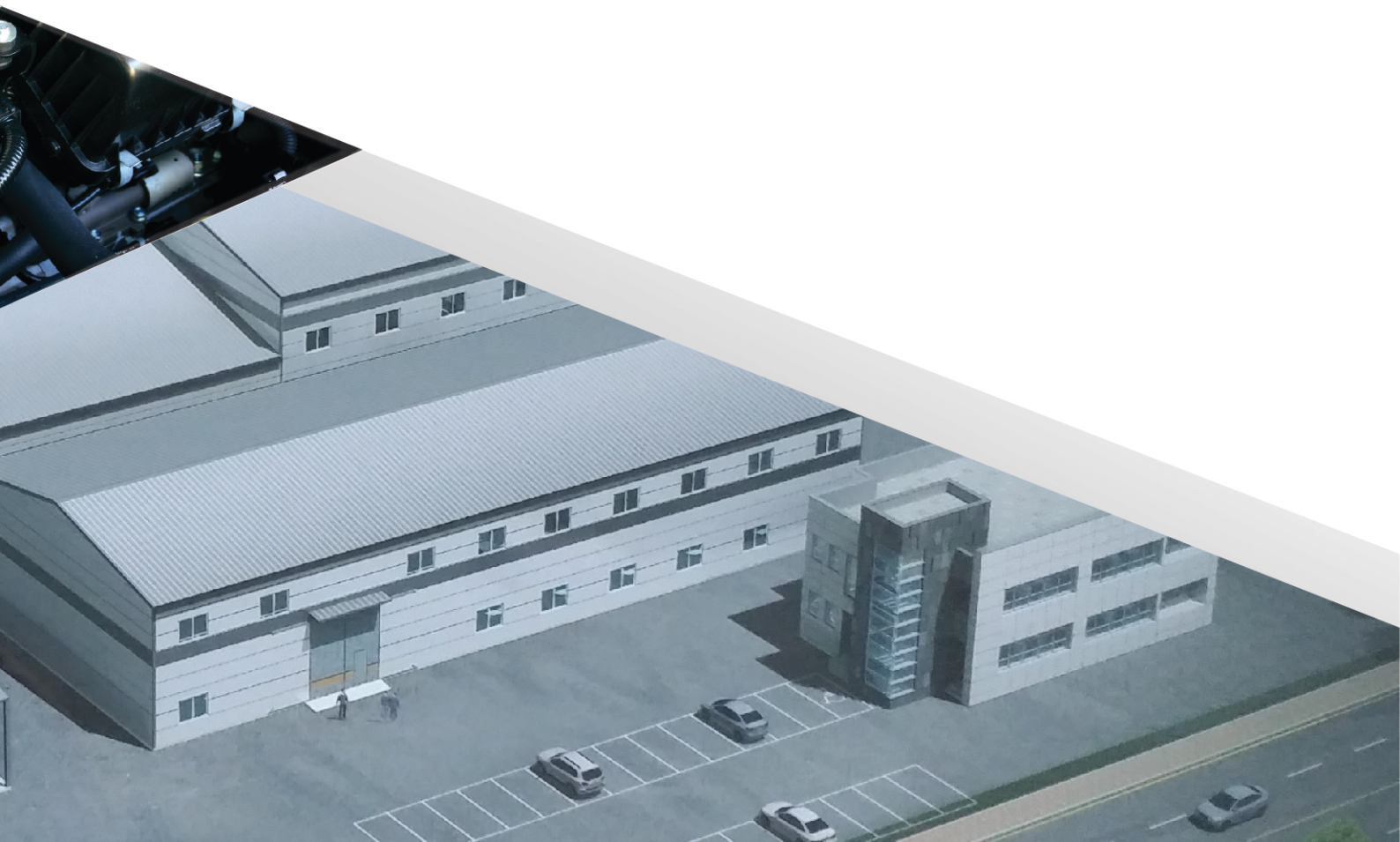

## CP PA6 GRADES

CATEGORY	GRADES	DESCRIPTION
MOLD RELEASE	CN100L	General uses, mold release
GLASS FIBER REINFORCED	CN120G	Medium viscosity, Glass fiber 20% reinforced
	CN130G	Medium viscosity, Glass fiber 30% reinforced
	CN135G	Medium viscosity, Glass fiber 35% reinforced
	CN150G	Medium viscosity, Glass fiber 50% reinforced
	CN160G	Medium viscosity, Glass fiber 60% reinforced
IMPACT MODIFIED	CN105E	Impact modified, 5%
	CN110E	Impact modified, 10%
	CN120E	Impact modified, 20%
	CN110GE	Glass fiber 10% Impact modified
	CN115GE	Glass fiber 15% Impact modified

## CP PA66 GRADES

CATEGORY	GRADES	DESCRIPTION
MOLD RELEASE	CN200L	General uses, mold release
GLASS FIBER REINFORCED	CN215G	Medium viscosity, Glass fiber 15% reinforced
	CN220G	Medium viscosity, Glass fiber 20% reinforced
	CN230G	Medium viscosity, Glass fiber 30% reinforced
	CN235G	Medium viscosity, Glass fiber 35% reinforced
	CN250G	Medium viscosity, Glass fiber 50% reinforced
	CN260G	Medium viscosity, Glass fiber 60% reinforced
GF REINFORCED, HEAT RESISTANT	CN230GH	Heat resistant, Glass fiber 30% reinforced
	CN235GH	Heat resistant, Glass fiber 35% reinforced
IMPACT MODIFIED	CN205E	Impact modified, 5%
	CN210E	Impact modified, 10%
	CN220E	Impact modified, 20%
CARBON FIBER REINFORCED	CN230C	Medium viscosity, Carbon fiber 30% reinforced

## CP PBT GRADES

CATEGORY	GRADES	DESCRIPTION
MOLD RELEASE	CB100L	General uses, mold release
	CB100S	Mold release, Dimensional stability
GLASS FIBER REINFORCED	CB115G	Medium viscosity, Glass fiber 15% reinforced
	CB130G	Medium viscosity, Glass fiber 30% reinforced
	CB530G	PBT Alloy, Glass fiber 30% reinforced
IMPACT MODIFIED	CB110E	Toughened, Unreinforced
FLAME RETARDANT	CB500V	Unfilled, Extrusion, Flame retardant
	CB115GV	Glass fiber 15% reinforced, Flame retardant
	CB130GV	Glass fiber 30% reinforced, Flame retardant

## CP POM GRADES

CATEGORY	GRADES	DESCRIPTION
GLASS FIBER REINFORCED	CP10G	General injection molding, Glass fiber 10%
	CP25G	General injection molding, Glass fiber 25%
IMPACT MODIFIED	CP10E	General injection molding, Impact modified, 10%
	CP20E	General injection molding, Impact modified, 20%

## CP BLACK MASTER BATCH

GRADES	BASE RESIN	CARBON, %	APPLICATION
MB940	LDPE	40%	Commodity resin for Extrusion/Injection molding
MB845	SAN	45%	ABS, PC, PBT, PC/ABS etc for Extrusion/Injection molding
MB745	GPPS	45%	PS sheet and compounding
MB550	WAX	50%	General engineering plastics, Wax type
MB130	PA	30%	Polyamides for Extrusion/Injection molding
MB230	PBT	30%	PBT/PET for Extrusion/Injection molding

## NOMENCLATURE

RESIN	FILLER	CHARACTERISTICS
CN1 PA6	G Glass fiber	L Mold release
CN2 PA66	M Milled fiber	H Heat resistant
CN5 PA Alloy	C Carbon fiber	U UV stabilized
CB1 PBT	T Mineral	V Non flammable
CB5 PBT/PET Alloy	E Elastomer	S Specialty
CP POM		

CONTENTS	COLOR
10 10%	None Natural color
20 20%	BK Black
30 30%	WH White
40 40%	GR Gray
50 50%	RD Red

RESIN	CONTENTS	FILLER	CHARACTERISTICS	COLOR
CN1	30	G	H	BK

#### **HEADQUARTER**

101-522, SK Ventium, 166 Gosan-ro, Gunpo-si, Gyeonggi-do, Korea  
TEL: +82-31-453-3451      E-Mail: [cppolymer@corpccp.com](mailto:cppolymer@corpccp.com)

#### **PLANT**

108, Sincheoksandan 4-ro, Deoksan-myeon, Jincheon-gun, Chungcheongbuk-do, Korea  
TEL: +82-43-532-0847

[www.cppolymer.com](http://www.cppolymer.com)